

## Step 1

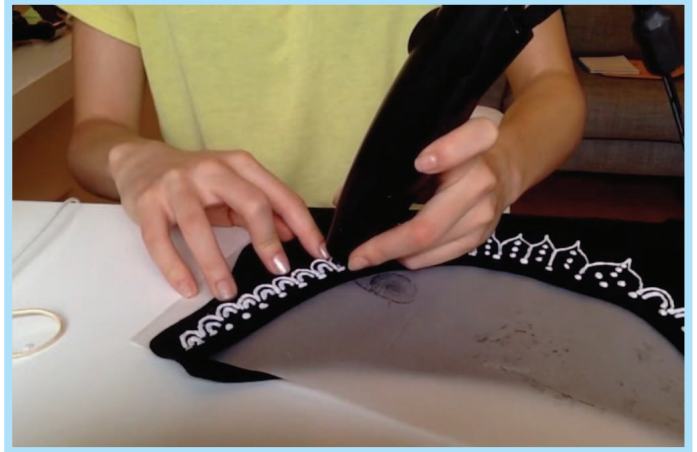

Choose a clothing you could like to doodle on and place tracing paper between the clothing.

## Step 2



Make sure you use PLA plastic for this doodle.

## Step 3

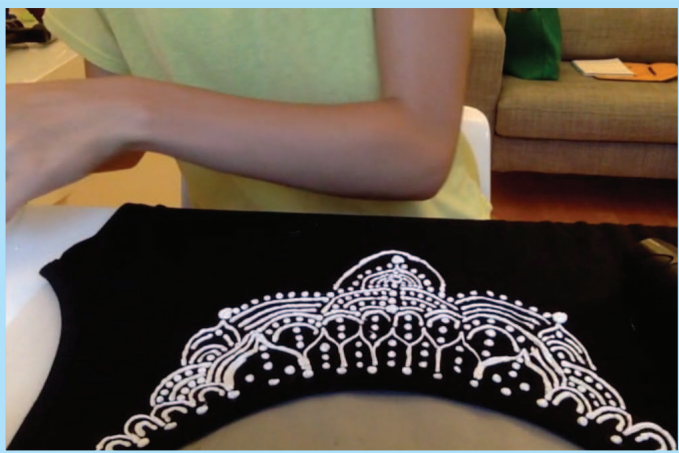

Decorate your own shirt.

## Tips

- Try not to doodle continuous designs. If you doodle smaller designs, the clothing will feel more flexible when you wear it.
- DO NOT wash this in the washing machine. Some 3Doodle plastic will not stay on the shirt permanently!

# Doodle on Shirt

By 3Doodler Community



## Final



Have fun designing your own clothing!

## Doodle on Shirt

By 3Doodler Community

